

Eazy Electric Convection Oven 6GN 1/1

ITEM # _____

MODEL # _____

NAME # _____

SIS # _____

AIA # _____

240007 (ZCD061L)

Compact Eazy, electric, 6x1/1GN, convection oven with direct steam and 11 humidity level settings, without automatic cleaning, left-hinged door

240009 (ZCD061R)

Compact Eazy, electric, 6x1/1GN, convection oven with direct steam and 11 humidity level settings, without automatic cleaning, right-hinged door

Short Form Specification

Item No. _____

Convection oven with direct steam: 90% steam saturation.

Cooking cycles: hot air (max 280 °C) combined with 11 different humidity settings, ranging from browning to baking and par-steaming. Programmability: 99 free recipes with 9-step cooking. Variable fan speed with 3 levels. Double-glass door with book-like opening maintains a cool external temperature and incorporates a drip pan to collect excess condensation avoiding wet floors. Halogen lighting in the cooking chamber. Door, front panel and interior in AISI 304 stainless steel.

Supplied with n.1 tray rack 1/1GN, 30mm pitch.

Main Features

- Dry hot convection cycle (max 280 °C) ideal for low humidity cooking. Automatic moistener (11 settings) for boiler-less steam generation:
 - 0 = no additional moisture (browning, au gratin, baking, pre-cooked food)
 - 1-2 = low moisture (small portions of meat and fish)
 - 3-4 = medium low moisture (large pieces of meat, reheating, roasted chicken and proving)
 - 5-6 = medium moisture (roasted vegetable and first step of roasted meat & fish)
 - 7-8 = medium-high moisture (stewed vegetables)
 - 9-10 = high moisture (poached meat and jacket potatoes)
- Programmability: a maximum of 99 recipes can be stored in the oven's memory, to recreate the exact same recipe at any time. 9-step cooking programs also available.
- Eco-delta: the temperature inside the cooking cell is higher than the temperature of the food and rises accordingly.
- Automatic and manual rapid cooling activation when going from a higher to a lower temperature.
- Exhaust valve electronically controlled to extract humidity in excess for extra crispy results.
- USB connection: to download HACCP data, upload/download the recipes.
- Variable fan speed with 3 levels.

Construction

- Hygienic internal chamber with all rounded corners for easy cleaning.
- Double thermo-glazed door with open frame construction, for cool outside door panel. Swing hinged easy-release inner glass on door for easy cleaning.
- Swing hinged front panel for easy service access to main components.
- IPx4 water protection.

APPROVAL: _____

Optional Accessories

• Pair of AISI 304 stainless steel grids, GN 1/1	PNC 922017	<input type="checkbox"/>
• Grid for whole chicken (4 per grid - 1,2kg each), GN 1/2	PNC 922086	<input type="checkbox"/>
• Pair of frying baskets	PNC 922239	<input type="checkbox"/>
• Grid for whole chicken (8 per grid - 1,2kg each), GN 1/1	PNC 922266	<input type="checkbox"/>
• Base support for stacked compact ovens	PNC 922368	<input type="checkbox"/>
• Open base for compact 6x1/1GN oven	PNC 922369	<input type="checkbox"/>
• Tray support for compact 6x1/1GN oven - open base	PNC 922370	<input type="checkbox"/>
• Stacking kit for compact 6x1/1GN oven	PNC 922371	<input type="checkbox"/>
• External spray unit for compact 6x1/1GN oven	PNC 922372	<input type="checkbox"/>
• 1-sensor core probe for compact 6x1/1GN oven	PNC 922373	<input type="checkbox"/>
• Right-hinged door for compact 6x1/1GN oven (only for 240007)	PNC 922376	<input type="checkbox"/>
• Double-step door for opening compact 6x1/1GN oven	PNC 922377	<input type="checkbox"/>
• Kit to front air filter for compact 6x1/1GN oven	PNC 922379	<input type="checkbox"/>
• Water inlet pressure reducer	PNC 922773	<input type="checkbox"/>
• Non-stick universal pan, GN 1/1, H=20mm	PNC 925000	<input type="checkbox"/>
• Non-stick universal pan, GN 1/1, H=40mm	PNC 925001	<input type="checkbox"/>
• Non-stick universal pan, GN 1/1, H=60mm	PNC 925002	<input type="checkbox"/>
• Double-face griddle, one side ribbed and one side smooth, GN 1/1	PNC 925003	<input type="checkbox"/>
• Aluminum grill, GN 1/1	PNC 925004	<input type="checkbox"/>
• Frying pan for 8 eggs, pancakes, hamburgers, GN 1/1	PNC 925005	<input type="checkbox"/>
• Flat baking tray with 2 edges, GN 1/1	PNC 925006	<input type="checkbox"/>
• Baking tray for 4 baguettes, GN 1/1	PNC 925007	<input type="checkbox"/>
• Non-stick universal pan, GN 1/2, H=20mm	PNC 925009	<input type="checkbox"/>
• Non-stick universal pan, GN 1/2, H=40mm	PNC 925010	<input type="checkbox"/>
• Non-stick universal pan, GN 1/2, H=60mm	PNC 925011	<input type="checkbox"/>

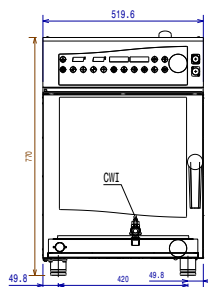
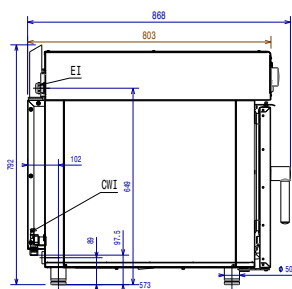
Front

Side

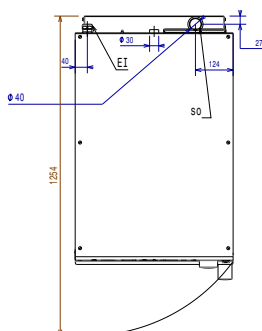
- CWI1** = Cold Water inlet 1 (cleaning)
CWI2 = Cold Water Inlet 2 (steam generator)
D = Drain
EI = Electrical inlet (power)

Top

Electric

Supply voltage: 400 V/3N ph/50/60 Hz
Electrical power, max: 6.9 kW
Circuit breaker required

Water:

Total hardness: 5-50 ppm
Electrolux Professional recommends the use of treated water, based on testing of specific water conditions.
 Please refer to user manual for detailed water quality information.

Pressure, min-max: 1.5-3 bar
Drain "D": 40mm
Water inlet "CW" connection: 3/4"

Installation:

Clearance: 5 cm rear and right hand sides.
Suggested clearance for service access: 50 cm left hand side.

Capacity:

Max load capacity: 12 kg
Trays type: 6 (GN 1/1)

Key Information:

External dimensions, Width: 519 mm
External dimensions, Depth: 803 mm
External dimensions, Height: 770 mm
Net weight: 72 kg
Shipping weight:
 240007 (ZCD061L) 85 kg
 240009 (ZCD061R) 82 kg
Shipping volume: 0.66 m³